

HANDLING ROBOT

WELDEX

ROBOTIC WELDING SOLUTION

www.weldex.co.th



website



facebook



map



P-05i HANDLING ROBOT

Reach
850mm
Payload
5KG

Functional Features
Fast, compact and flexible,
Handling, loading and unloading

Working Range Diagram

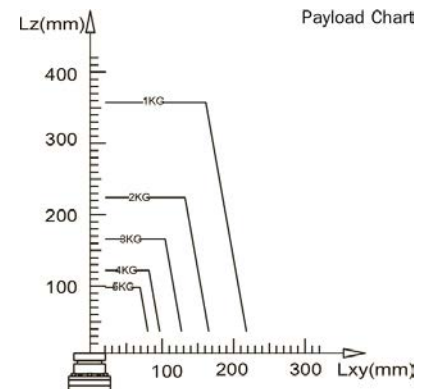
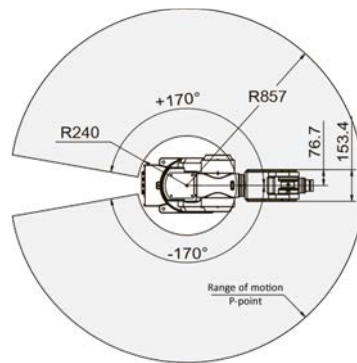
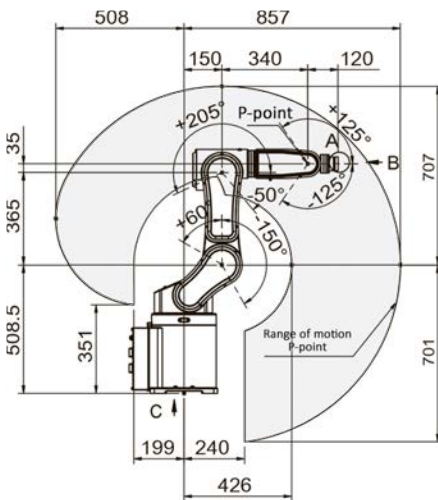

Technical Parameter

Model	P-05i	Axis	Range of motion	Maximum speed
Number of axis	6	J1	±170°	145° /S
Maximum payload	5KG	J2	+60° ~ -150°	133° /S
Reach	850mm	J3	+205° ~ -50°	140° /S
Position repeatability	±0.03mm	J4	±130°	172° /S
Power requirement	1.6KVA	J5	±125°	172° /S
Use environment	0-45°C 20-80%RH (No condensation)	J6	±360°	210° /S
Body weight	60KG			
Installation method	Ground, side mounting, hoisting			
Protection level	Equivalent to IP65			



P-14-10 HANDLING ROBOT

Reach
1430mm
Payload
10KG

Functional Features

Strong versatility and easy maintenance
Handling/stacking, loading and unloading

Working Range Diagram

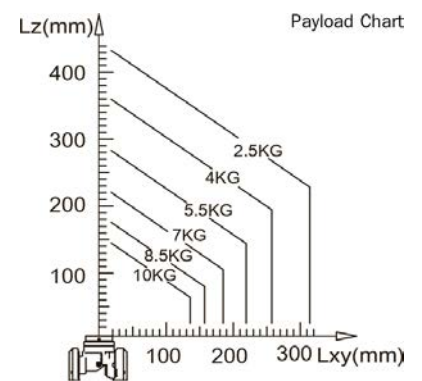
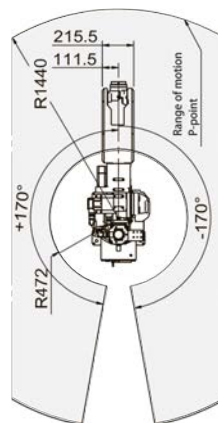
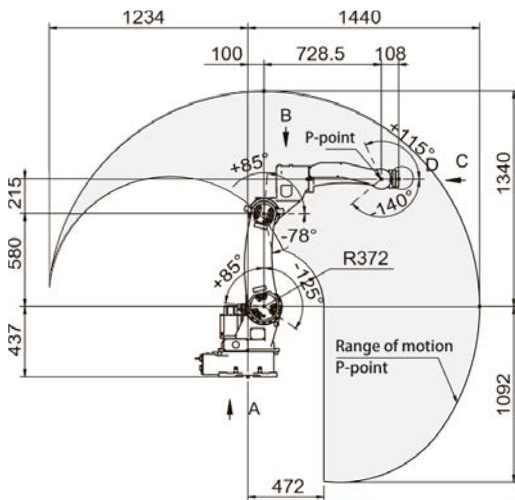

Technical Parameter

Model	P-14-10	Axis	Range of motion	Maximum speed
Number of axis	6	J1	±170°	180° /S
Maximum payload	10KG	J2	+85° ~ -125°	133° /S
Reach	1430mm	J3	+85° ~ -78°	140° /S
Position repeatability	±0.08mm	J4	±170°	217° /S
Power requirement	3.0KVA	J5	+115° ~ -140°	172° /S
Use environment	0-45°C 20-80%RH (No condensation)	J6	±360°	172° /S
Body weight	170KG			
Installation method	Ground, Hoisting			
Protection level	IP54/IP65 (Wrist)			



P-16-20 HANDLING ROBOT

Reach
1680mm
Payload
20KG

Functional Features

Strong versatility and wide range
Handling/stacking, loading and unloading

Working Range Diagram

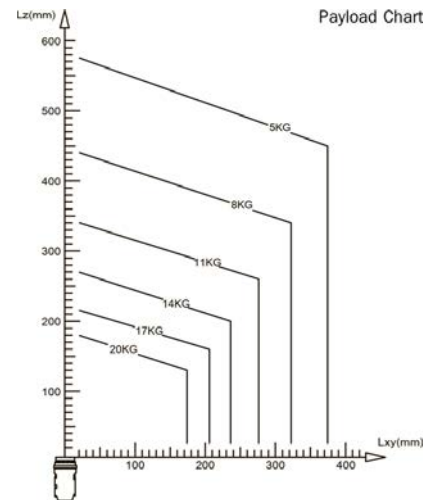
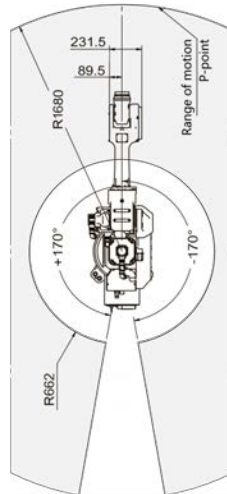
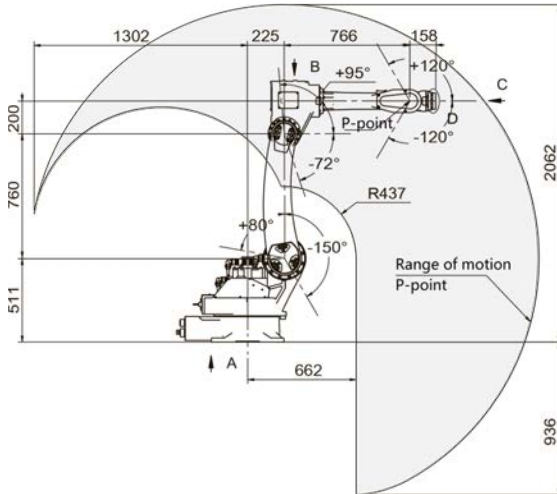

Technical Parameter

Model	P-16-20	Axis	Range of motion	Maximum speed
Number of axis	6	J1	±170°	150° /S
Maximum payload	20KG	J2	+80° ~ -150°	140° /S
Reach	1680mm	J3	+95° ~ -72°	140° /S
Position repeatability	±0.08mm	J4	±170°	173° /S
Power requirement	8.0KVA	J5	±120°	172° /S
Use environment	0-45°C 20-80%RH (No condensation)	J6	±360°	332° /S
Body weight	330KG			
Installation method	Ground, Hoisting			
Protection level	IP54/IP65 (Wrist)			



P-20-50 HANDLING ROBOT

Reach
2200mm
Payload
50KG

Functional Features

Easy maintenance, large working radius
Handling/stacking, loading and unloading

Working Range Diagram

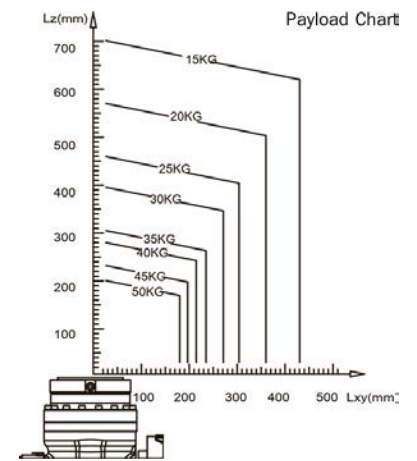
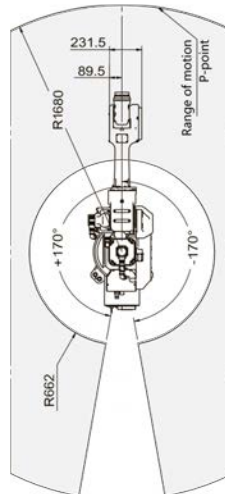
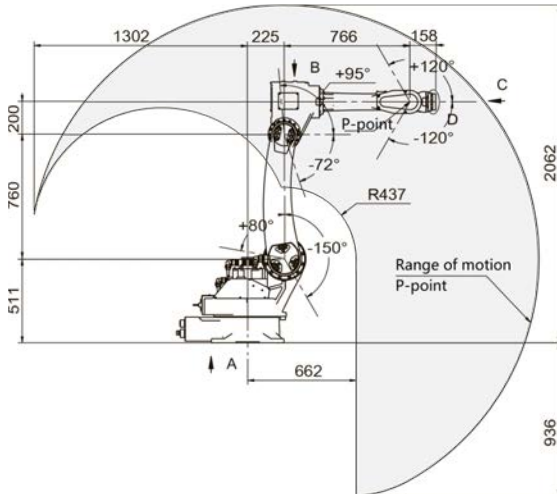

Technical Parameter

Model	P-20-50	Axis	Range of motion	Maximum speed
Number of axis	6	J1	±170°	70° /S
Maximum payload	50KG	J2	+100° ~ -112°	95° /S
Reach	2200mm	J3	+130° ~ -75°	99° /S
Position repeatability	±0.08mm	J4	±200°	201.5° /S
Power requirement	8.0KVA	J5	±125°	145° /S
Use environment	0-45°C 20-80%RH (No condensation)	J6	±360°	217° /S
Body weight	520KG			
Installation method	Ground			
Protection level	IP54/IP65 (Wrist)			



F-14-10 HANDLING ROBOT

Reach
1400mm
Payload
10KG

Functional Features

More efficient and easy to maintain,
Handling/stacking, loading and unloading

Working Range Diagram

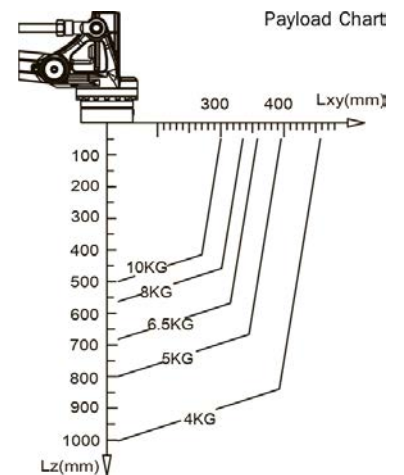
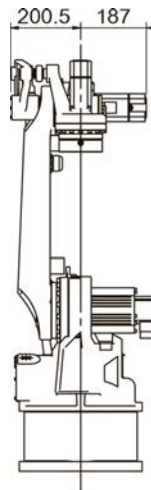
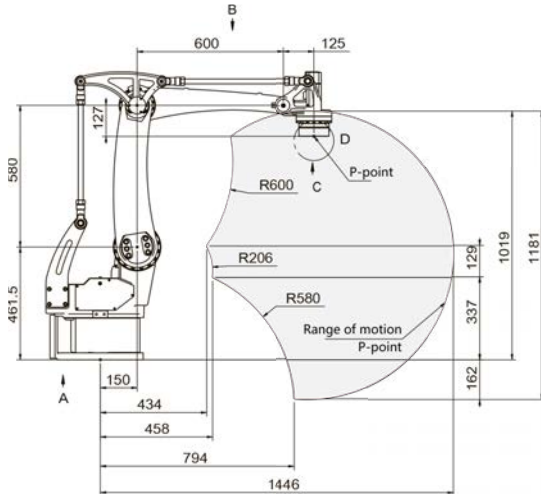

Technical Parameter

Model	F-14-10	Axis	Range of motion	Maximum speed
Number of axis	4	J1	$\pm 170^\circ$	$190^\circ / S$
Maximum payload	10KG	J2	$+10^\circ \sim +125^\circ$	$120^\circ / S$
Reach	1400mm	J3	$+10^\circ \sim -95^\circ$	$120^\circ / S$
Position repeatability	$\pm 0.08\text{mm}$	J4	$\pm 360^\circ$	$200^\circ / S$
Power requirement	3.7KVA			
Use environment	0-45°C 20-80%RH (No condensation)			
Body weight	170KG			
Installation method	Ground			
Protection level	IP54/IP65 (Wrist)			



F-18-20 HANDLING ROBOT

Reach
1800mm
Payload
20KG

Functional Features

More efficient and easy to maintain
Handling, palletizing, loading and unloading

Working Range Diagram

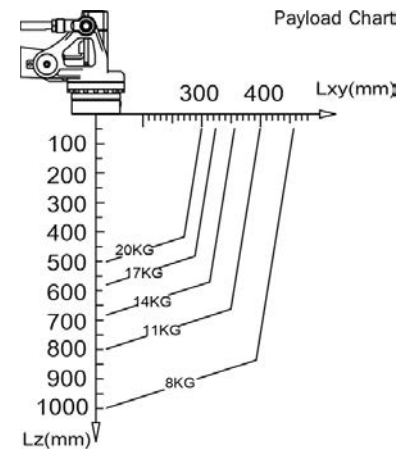
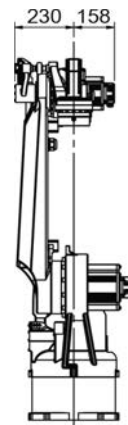
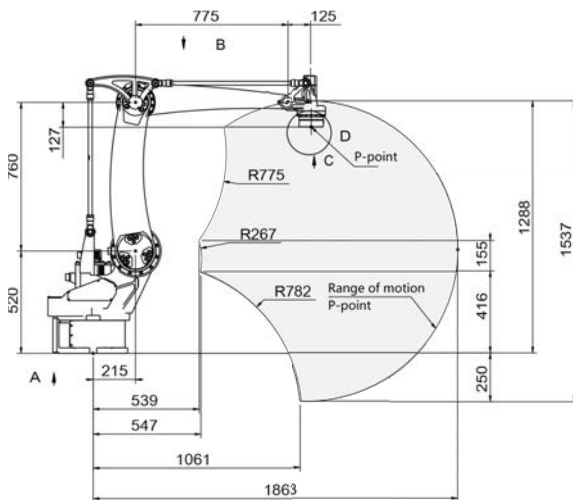

Technical Parameter

Model	F-18-20	Axis	Range of motion	Maximum speed
Number of axis	4	J1	$\pm 170^\circ$	$150^\circ / S$
Maximum payload	20KG	J2	$+125^\circ \sim +10^\circ$	$142^\circ / S$
Reach	1800mm	J3	$+10^\circ \sim -92^\circ$	$145^\circ / S$
Position repeatability	$\pm 0.08\text{mm}$	J4	$\pm 360^\circ$	$200^\circ / S$
Power requirement	6.0KVA			
Use environment	0-45°C 20-80%RH (No condensation)			
Body weight	280KG			
Installation method	Ground			
Protection level	IP54/IP65 (Wrist)			



F-32-165 HANDLING ROBOT

Reach
3150mm
Payload
165KG

Functional Features

4-axis heavy load, more efficient
Handling, palletizing, loading and unloading

Working Range Diagram

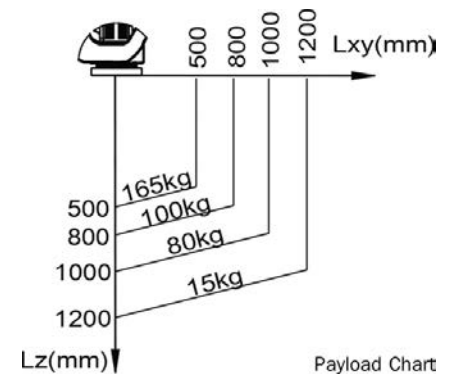
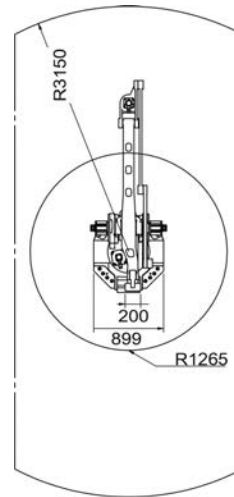
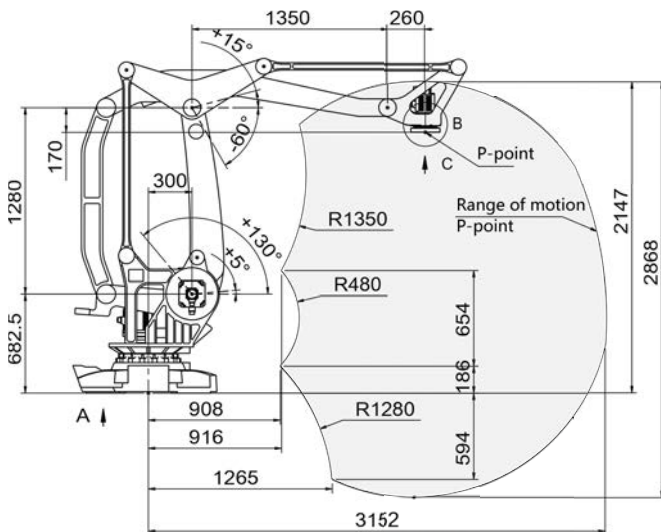

Technical Parameter

Model	F-32-165	Axis	Range of motion	Maximum speed
Number of axis	4	J1	±180°	70° /S
Maximum payload	165KG	J2	+5° ~ +130°	82° /S
Reach	3150mm	J3	+15° ~ -60°	82° /S
Position repeatability	±2mm	J4	±360°	200° /S
Power requirement	10KVA			
Use environment	0-45°C 20-80%RH (No condensation)			
Body weight	1500KG			
Installation method	Ground			
Protection level	IP54/IP65 (Wrist)			