

# W-14i

1440 mm Arc Welding Robot



## SPECIFICATION

MODEL	W-14iE
Type	1.4m Economic 350A
Range	1440mm
Structure	6 Axis Articulated
Payload	6kg
Repeatability	±0.08mm
Environmental Conditions	0-45°C 20-80%RH
Protection Class	IP23
Weight	170kg
Welding M/C	CM350
Controller	W-LNC-R8800
Cable	5m TP-Cable
Isolator Box	4kVA (3P+E > 3P+N+E)
Robot Stand	50cm

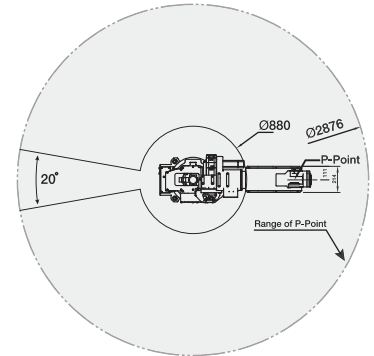
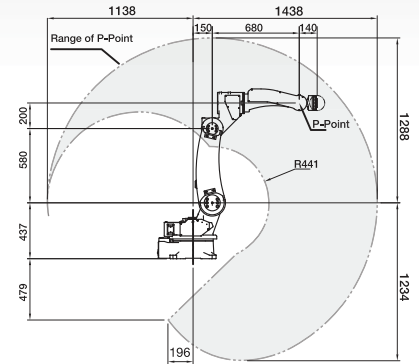



### Feature Description

- Handheld touch-screen
- Digital multiaxial control (Maximum 9 axis)
- Handheld touch-screen and 1.2 meter Anti-shock design
- IP65 waterproof and dustproof level
- Built-in MPG makes operation easier.
- Welding templet function can produce path quickly.
- Application page can be used easily for editing working procedure.

### SPECIFICATION

Monitor	7"
Operational Panel	40 buttons
PC Interface	SD Card
Safety switch	2 stage switch (Std.)
Emergency stop	1

Communication cord	5m (Std.)
Input	128
Output	128
USB	USB host (2.0)
EtherNET	10BASE-T/100BASE-TX

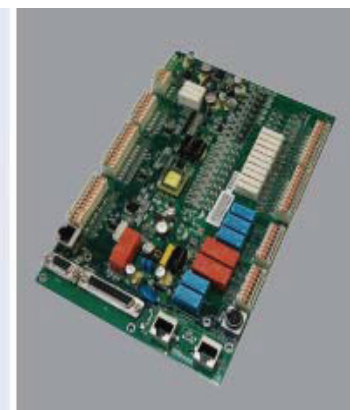

RW8800 Series Welding Robot Controller, which apply to welding industry. The controller includes welding art bag to reach the diversity requirements such as dot correction, arc welding, spot welding, and welding bead tracking, and it supplies diversity welding machine's integration interface for further. The teaching pendant of robot strengthens durability and IP65 level waterproof and dustproof design, which is able to resistance external hash environment. Besides, built-in MPG is easily to operate and improve requirements of safety.